

FOR MODERN HOME CREATORS



DRILL-FREE INSTALLATION GUIDE

Model
A2000
A2175
A2180BDF
C207DF
Series

CUSTOMER SERVICES

keshome.com
cs@keshome.com



CHAT NOW

DRILL-FREE INSTALLATION

Max Load : 5kg/11lbs

Notice : Drill-free installation is suitable for flat and smooth surfaces without dust or water , such as tile , glass and metal . DO NOT apply this product on painted wall nor wallpaper as it may cause damage to these surfaces . Please wait for 12 hours before use.

Illustrations are for installation reference only.

1. Clean the surface with rubbing alcohol and allow to dry. DO NOT use household cleaners. Make sure the surface has no dust, dirt or grease before applying.

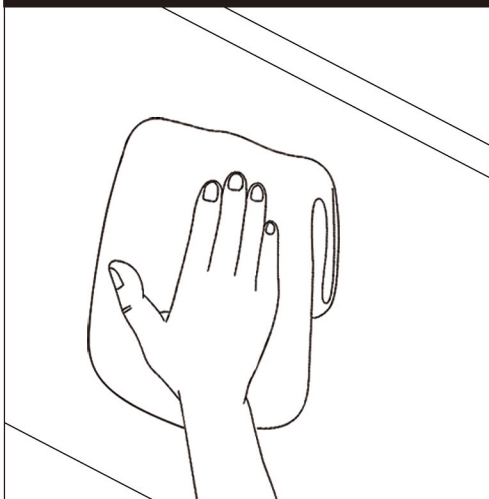

2. Carefully remove the protective backing. Be careful not to touch the adhesive surface.

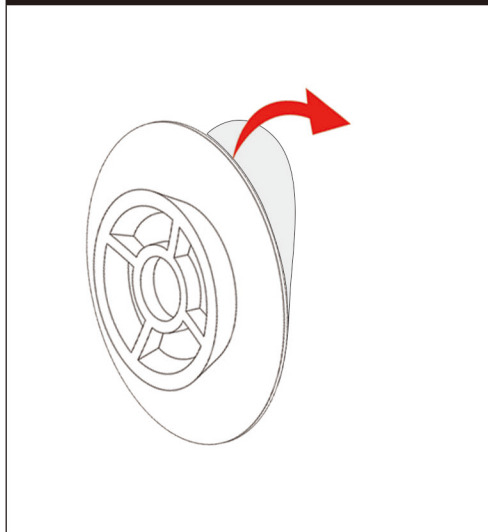

3. Firmly press the base of the product to the desired surface for 30 seconds.

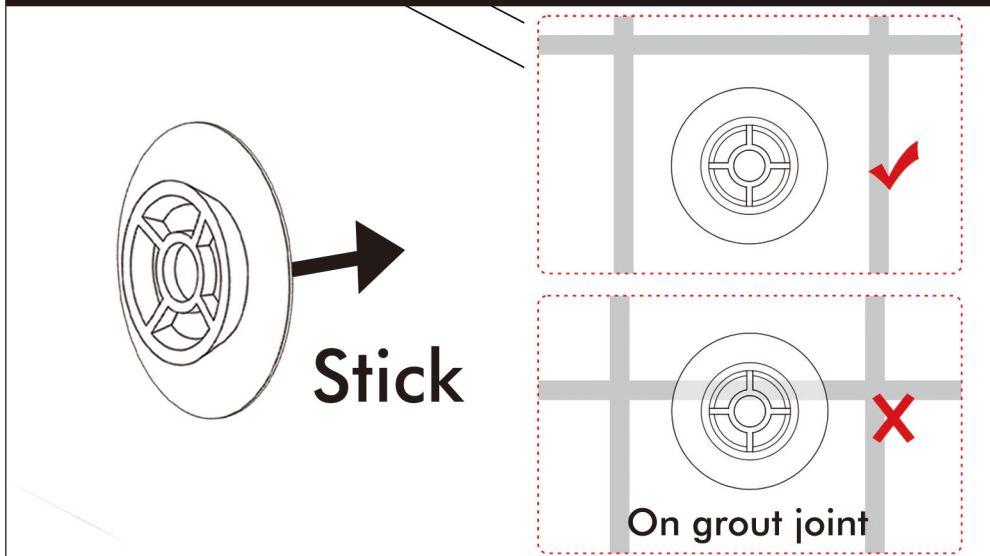

4. Wait 12 hours before using the product.
NOTE: Indoor use only.
Temperature Range : 50°F-105°F.

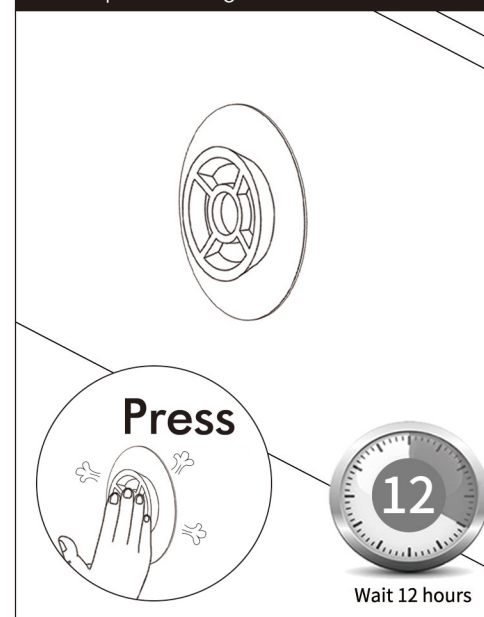

5

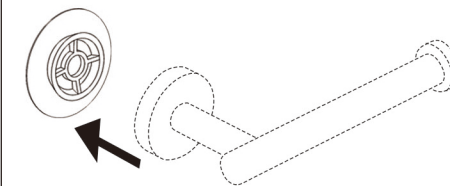

6

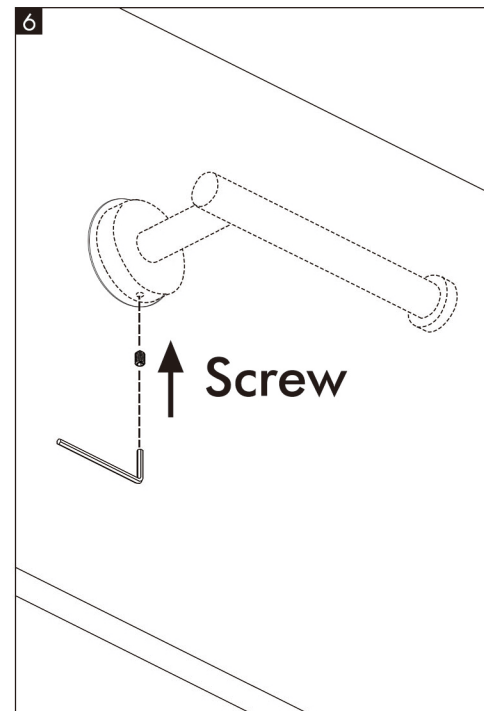

7

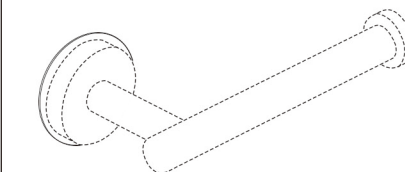

After-sale Service



24- Hour Customer Support

Visit our customer support center at www.keshome.com/cs, available 24/7. Contact us via Amazon Message, instant chat, and email during business hours.



Free Replacement Parts

Please contact us if any parts are damaged or missing. Parts provided free. (Shipping fees may apply)



1-on-1 Responsive Customer Service

No need to restate your case with each contact. Our dedicated team of professionals will work on resolving your issue until it is resolved.



Parts Customization

No need to worry about unexpected challenges. Share your requirements, and we'll customize parts to meet your specific needs.



Return Policy

Feel free to return within 30 days. Please ensure all items (particularly the hardware pack) are in the box before returning.

Missing Return Window?

No Worry!
We totally understand



Contact us
Replace for FREE



EN Warning: Hard Metal Surface – Avoid Impact and Dropping.

DE Warnung: Harte Metalloberfläche – Aufprall und Fallenlassen vermeiden.

FR Avertissement: Surface en métal dur – Évitez les chocs et les chutes.

ES Advertencia: Superficie de metal duro – Evite golpes y caídas.

IT Avvertenza: Superficie metallica dura – Evitare urti e cadute.

PL Ostrzeżenie: Twarda metalowa powierzchnia – Unikaj uderzeń i upadków.

NL Waarschuwing: Harde metalen oppervlakte – Vermijd stoten en laten vallen.

SV Varning: Hård metall-yta – Undvik stötar och att tappa.

TR Uyarı: Sert Metal Yüzey – Darbe ve Düşürmekten Kaçının.

One-Year Limited Warranty

KES warrants its products purchased from authorized sellers to be free from defects in material and workmanship for one (1) year from the original date of purchase.

What We Will Do

KES will repair or replace, FREE OF CHARGE, during the one (1) year warranty period, any part that proves defective in material and/or workmanship under normal installation, use and service. If repair or replacement is not practical, KES may elect to refund the purchase price in exchange for the return of the product.

What Is Not Covered

KES shall not be liable for any damage to the product resulting from reasonable wear and tear, installation and maintenance errors, outdoor use, freezing water, abuse, misuse, and use of cleaners containing abrasive cleansers, ammonia, bleach, acids, waxes, alcohol or other organic solvents.

KES is not responsible for removal, installation, labor charges, or other incidental or consequential costs. In no event shall the liability of KES exceed the purchase price of the product.

KES AND/OR SELLER ARE PROVIDING THESE WARRANTIES IN LIEU OF ALL OTHER WARRANTIES, EXPRESSED OR IMPLIED, INCLUDING BUT NOT LIMITED

TO THE IMPLIED WARRANTIES OF MERCHANTABILITY AND FITNESS FOR A PARTICULAR PURPOSE. KES AND/OR SELLER DISCLAIM ALL LIABILITY FOR SPECIAL, INCIDENTAL OR CONSEQUENTIAL DAMAGES.

Some jurisdictions do not allow the exclusion or limitation of incidental or consequential damages, so these limitations and exclusions may not apply to you. This warranty gives you specific legal rights and you may also have other rights which vary from jurisdiction to jurisdiction.

This warranty applies only to KES products sold in North America and Europe.

Contact KES

Email: cs@keshome.com

Online Contact:



Please provide:

- dated proof of purchase
- description of the defect/fault
- picture or video showing the issue(s) (optional)



FR
Pensez à
donner ou recycler.



ou



ou



<https://quefairedemesdechets.fr>